

# 747 Bimini Twist Circle - Lexington, SC 29072



Blythe Builders Custom Home (less than 2 yrs old) on private River District lot with gorgeous pool! Stunning finishes with loads of upgrades: wide plank hickory floors; extensive moldings; specialty lighting, hardware & plumbing fixtures just to name a few. \$949,900.

## Property Details

5 Bedroom(s)  
4 Bath(s)  
1 Half Bath(s)

## SQFT

Total	3857
Main Level	2217
Upper Level	1640
Garage	670



## Bobby Curtis

Office Phone: 803-799-8035  
Cell Phone: 803-513-1095  
bobblyncurt@aol.com  
<http://bobblyncurtishomes.com>

Information is deemed reliable but not guaranteed!



COLDWELL BANKER  
REALTY

# 747 Bimini Twist Circle - Lexington, SC 29072

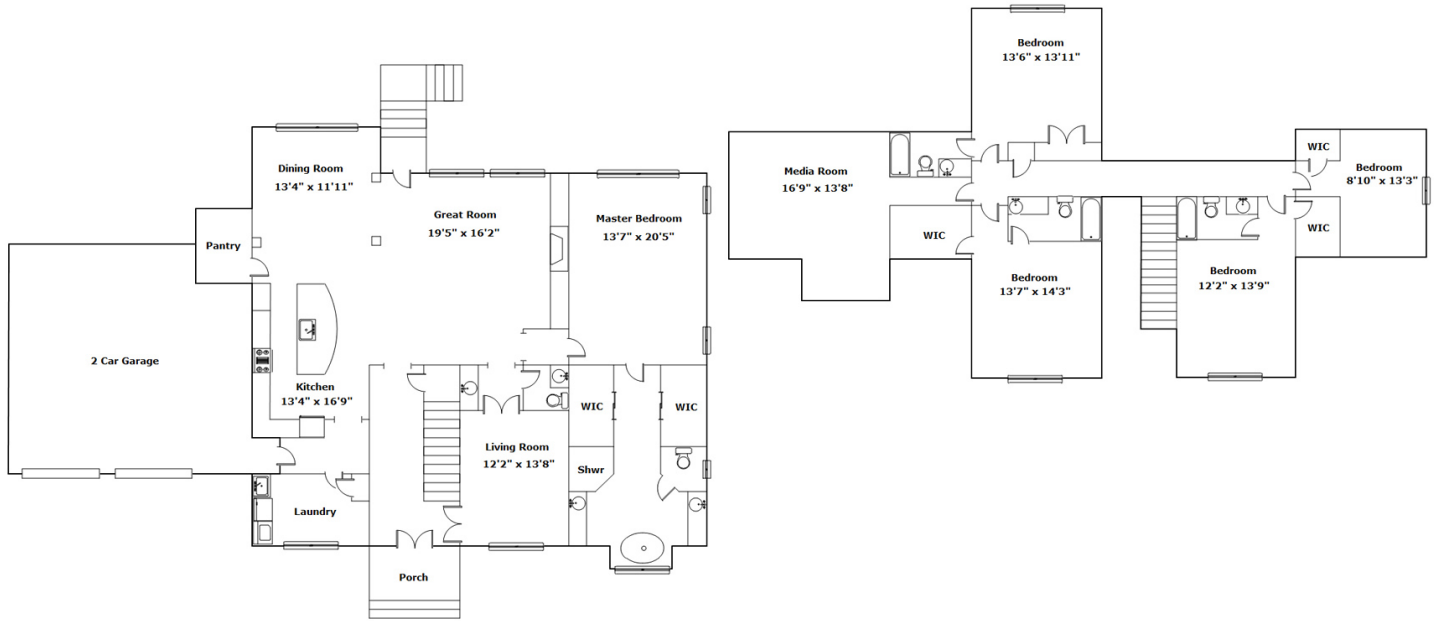

**Drawn by:** Look2 Homes Columbia

<http://www.look2homes.com/l2fp/floorplan/index.php?oid=21102>



**Bobby Curtis**

Office Phone: 803-799-8035

Cell Phone: 803-513-1095

[boblyncurt@aol.com](mailto:boblyncurt@aol.com)

<http://bobbycurtishomes.com>

Information is deemed reliable but not guaranteed!



**COLDWELL BANKER**  
**REALTY**