

# 213 Pointe Overlook Dr - Chapin, SC 29036



**Presenting a beautiful home for your consideration!**

## Property Details

4 Bedroom(s)  
3 Bath(s)

## SQFT

Total	3091
Main Level	2697
Upper Level	394
Garage	542

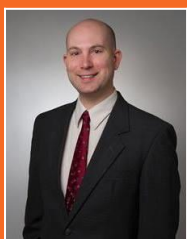

### Jim Leitherer

Office Phone: 803-915-8317  
Cell Phone: 803-298-0054  
jimleitherer@gmail.com

Information is deemed reliable but not guaranteed!



# 213 Pointe Overlook Dr - Chapin, SC 29036

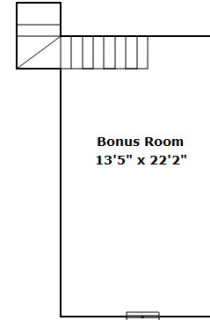
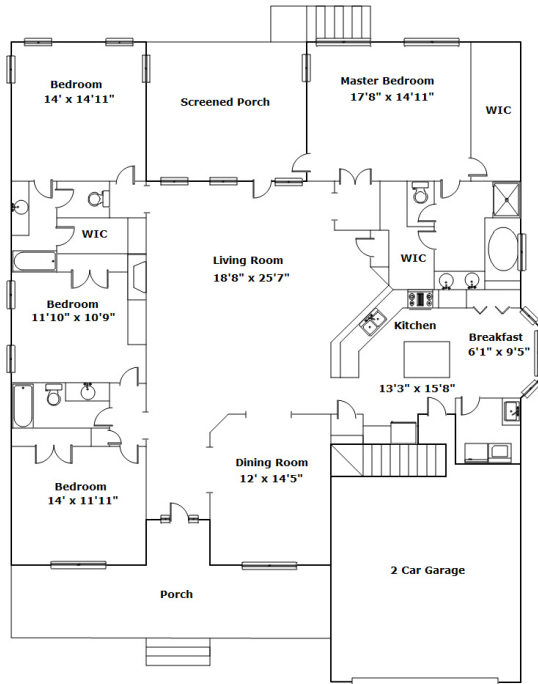

**Drawn by:** Look2 Homes Columbia

<http://www.look2homes.com/l2fp/floorplan/index.php?oid=20159>



**Jim Leitherer**

Office Phone: 803-915-8317

Cell Phone: 803-298-0054

[jimleitherer@gmail.com](mailto:jimleitherer@gmail.com)

Information is deemed reliable but not guaranteed!

